



LED Upgrade Installation



SHUT OFF POWER TO RANGE BEFORE PERFORMING WORK



The image below is a fragmented view of all the parts necessary for the new LED installation, and all parts completed:

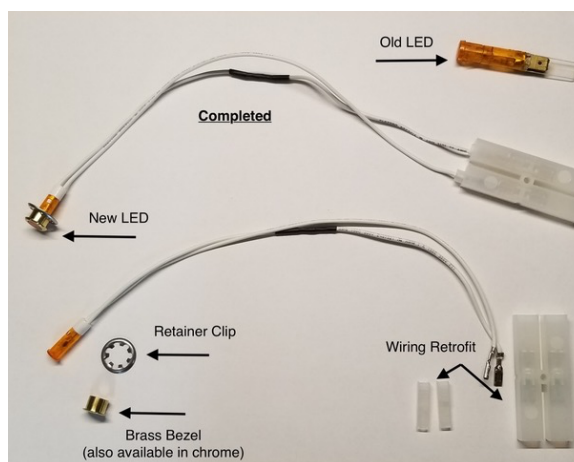

Be sure to replace one LED at a time as not to confuse the location of each LED. Remove each wire connector from the back of the old LED. You will need to remove the plastic clip from the ends of each wire by prying open the clip with a small flathead screwdriver and pulling the clip off the spade connector.

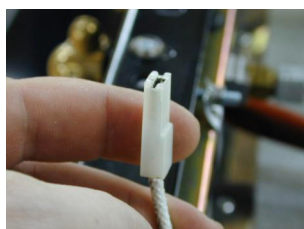

Next, insert each spade connector into the clear plastic wiring coupler like shown.

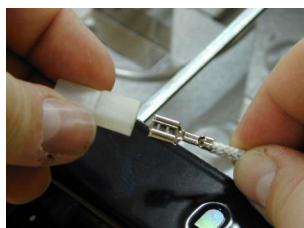

Art Culinaire | Lacanche USA, 1701 1st Street, Snohomish, WA 98290
www.frenchranges.com 1-888-222-2930

Remove the old LED by pushing it through the control panel from the rear and pulling it out the front. Then with the tiny white insulator clips on the new LED wire ends, fish both wires through the hole in the control panel.

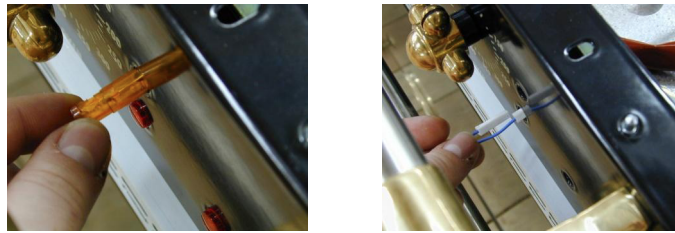

Gently push the metal bezel through the hole. If you encounter any resistance due to a tight fit, apply steady pressure while rotating the bezel in a circular motion using your thumb. This action should help widen the opening by removing excess material and facilitate the insertion of the LED into the hole.

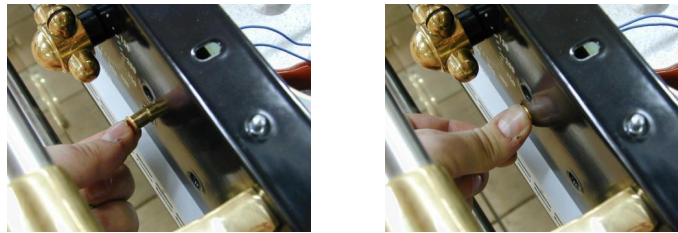

Thread the wire ends through the circular retainer clip with the teeth on the clip pointed towards the wire ends like shown. While pushing on the front of the LED, slide the retainer clip over the bezel until firmly seated to the control panel.

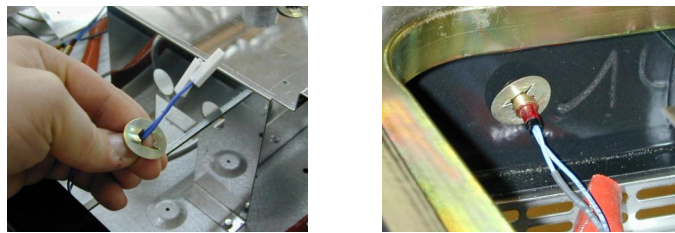

Place the LED wire ends into the wiring coupler and seat them fully into place using a small blunt tool like shown. Note: Since polarity is not an issue, the position of each LED wire can be positioned in either side of the coupler.

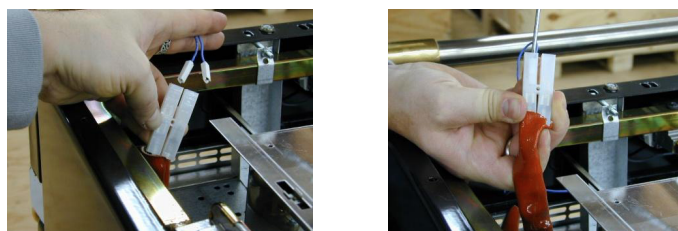

Pull the silicone sheathing over the wire coupler and repeat this process on remaining LED's.

